

Figure 4-9. EFTC Installed

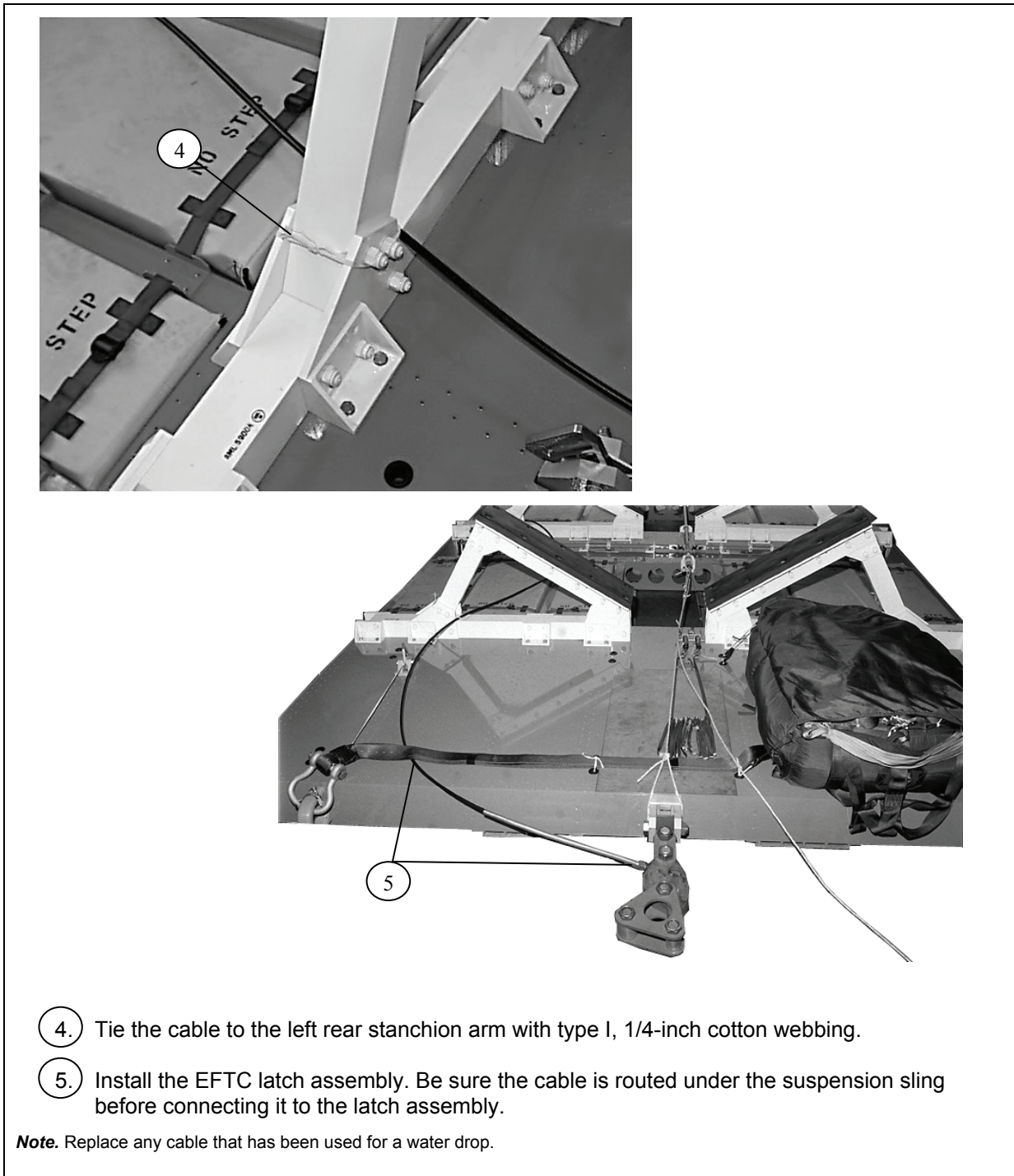

Figure 4-9. EFTC Installed (continued)

LIFTING AND POSITIONING BOAT

4-5. Use the lift kit provided with the boat (four long slings, three short loops, and clevises, instructions) to place the boat onto the cradles as shown in Figure 4-10. Be sure that the Airdrop Boat Preparation Checklist has been completed and signed before proceeding with the preparation of the boat.

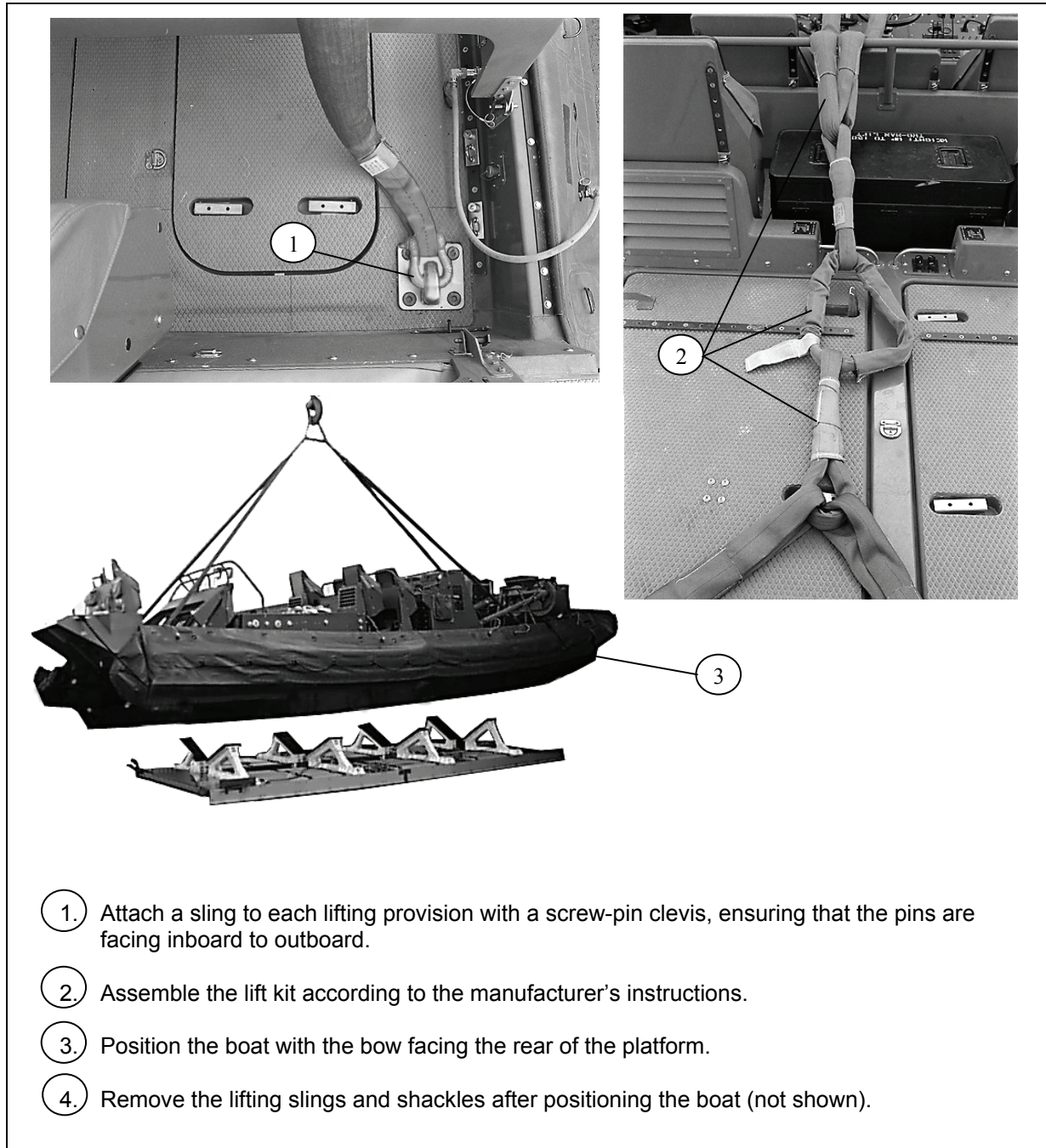

Figure 4-10. Boat Lifted and Placed on Platform



5. Align the rear edge of the transom with the front edge of the platform, disregarding the rubber bumpers.

Figure 4-10. Boat Lifted and Placed on Platform (continued)

PREPARING BOAT

4-6. Prepare the boat as shown in Figures 4-11 through 4-16.

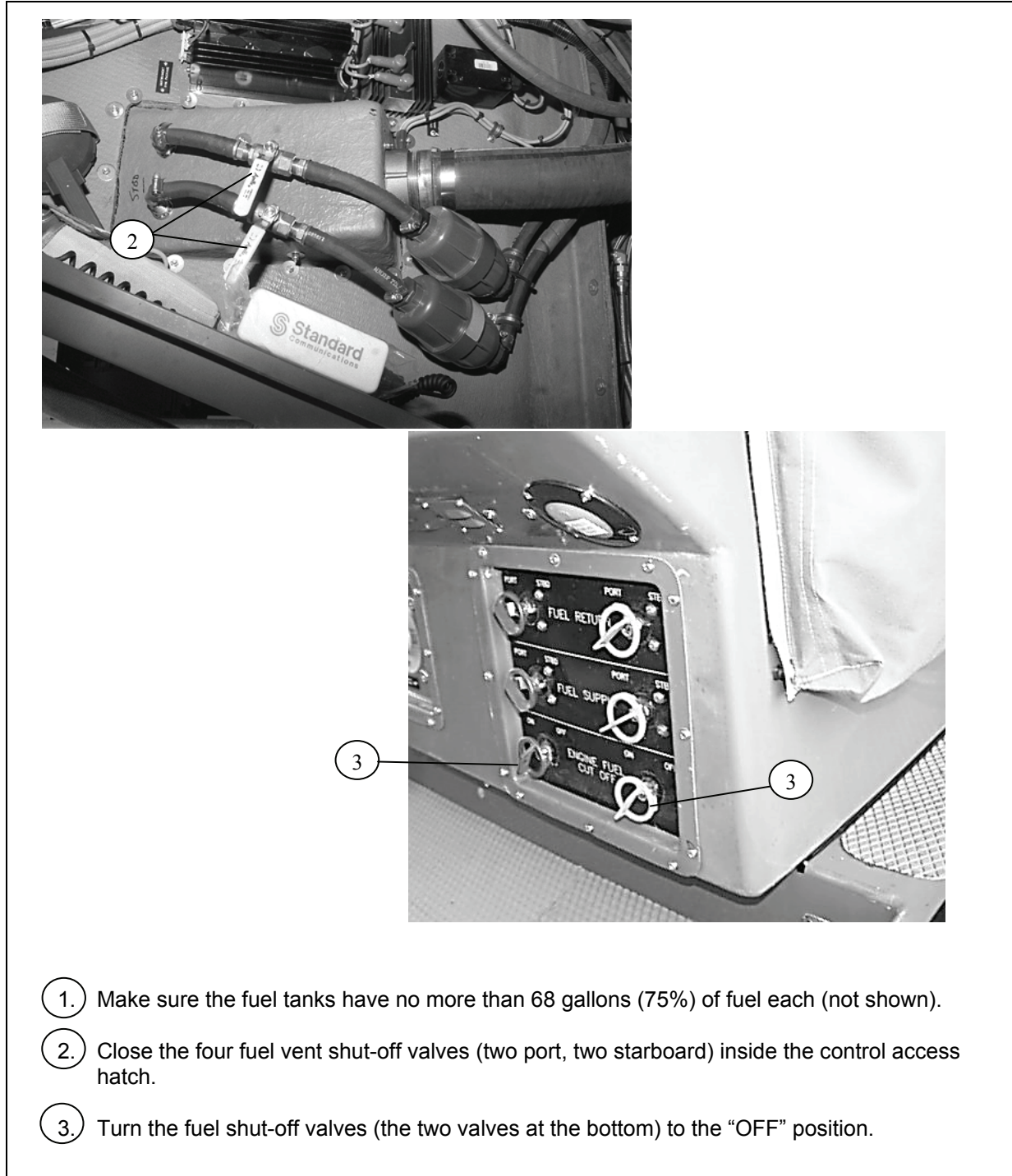
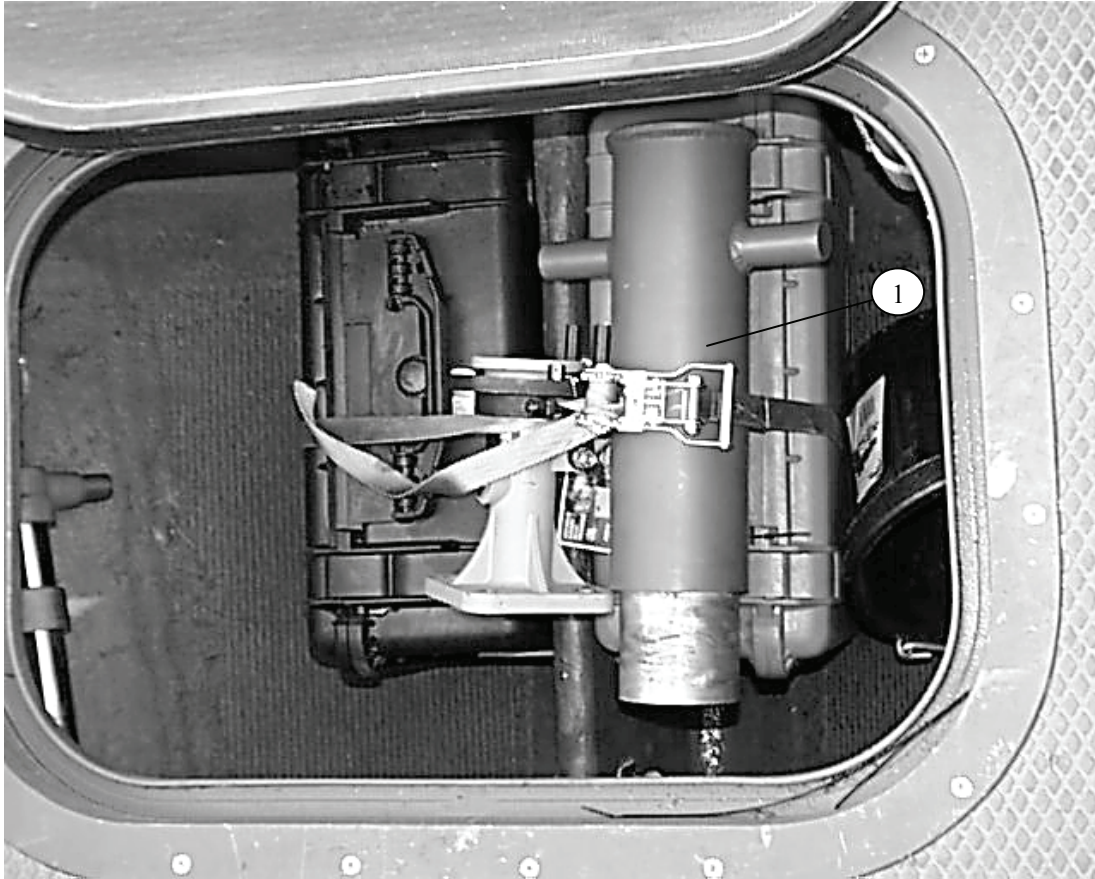
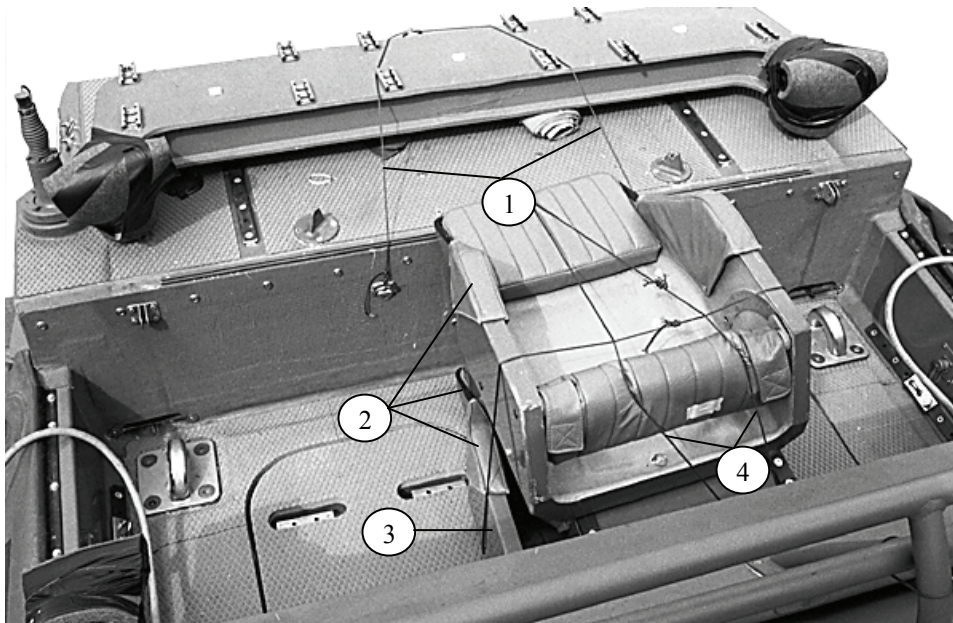

Figure 4-11. Fuel System Prepared



1. Remove the forward tow post. Stow and secure it in a convenient location.

Figure 4-12. Boat Equipment Stowed in Hatch



Note. When the fourth row of bolster seats is removed for missions not needing them, steps 1 through 4 may be omitted.

1. Remove the bolster seats from row 4. Remove the life ring and stow it in hold 2. Fold the row 4 bolster frame back on the rolled and tied splash guard. Secure the bolster frame with a length of type III nylon cord through the left and right deck rings on the swimmer deck, and through the center deck ring at the back of the swimmer deck.
2. Center one seat on the floor face up. Place a second seat squarely over the first face down. Place the third seat over the second face up.
3. Tie all three seats together with a length of type III nylon cord.
4. Run a length of type III nylon cord through the deck ring under the third bolster seat row, up through the handle of seat two, over the top seat, and to the top center deck ring on the swimmer deck. Tie both running ends on top of the seats.

Figure 4-13. Bolster Seats Stowed

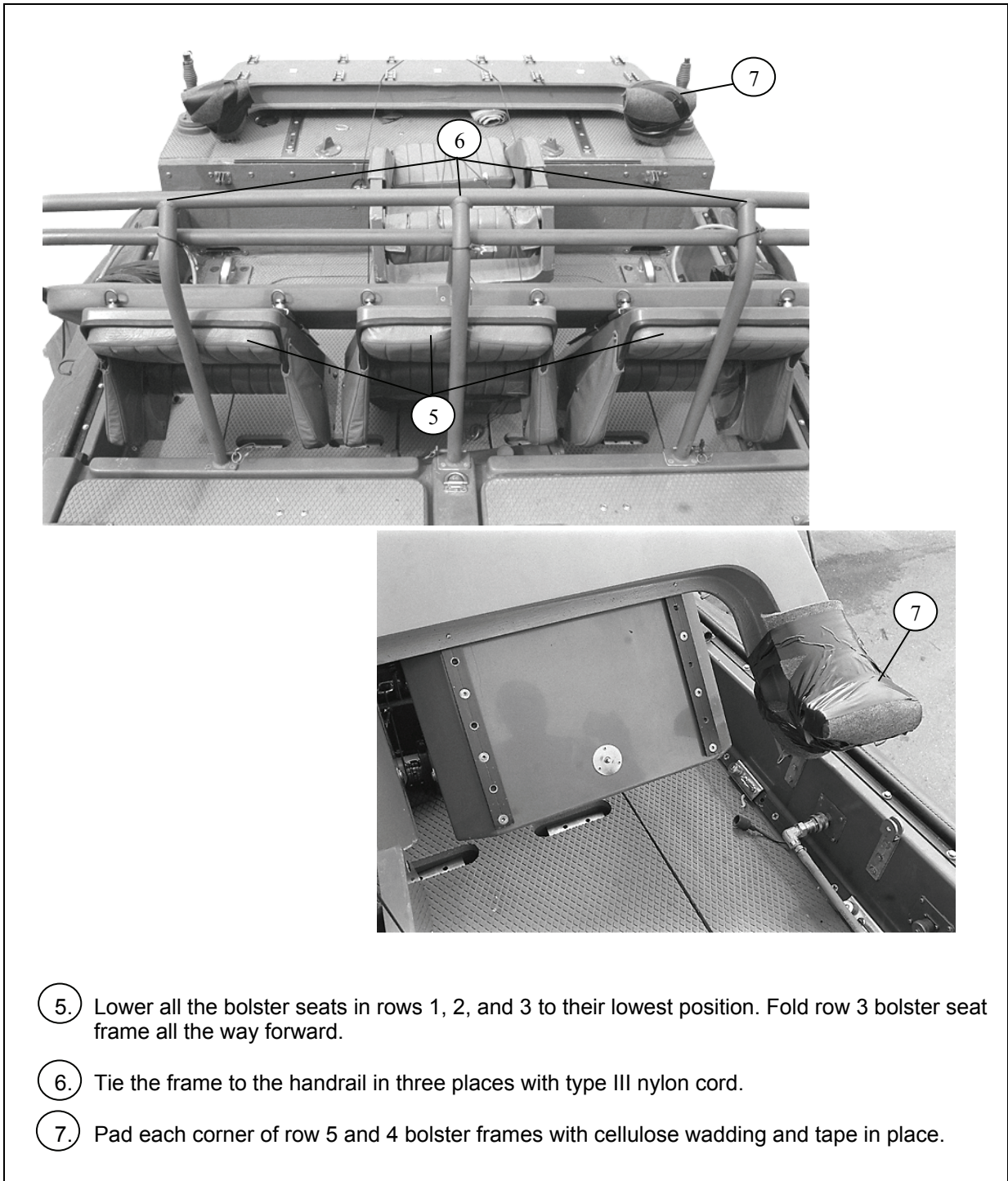

Figure 4-13. Bolster Seats Stowed (continued)

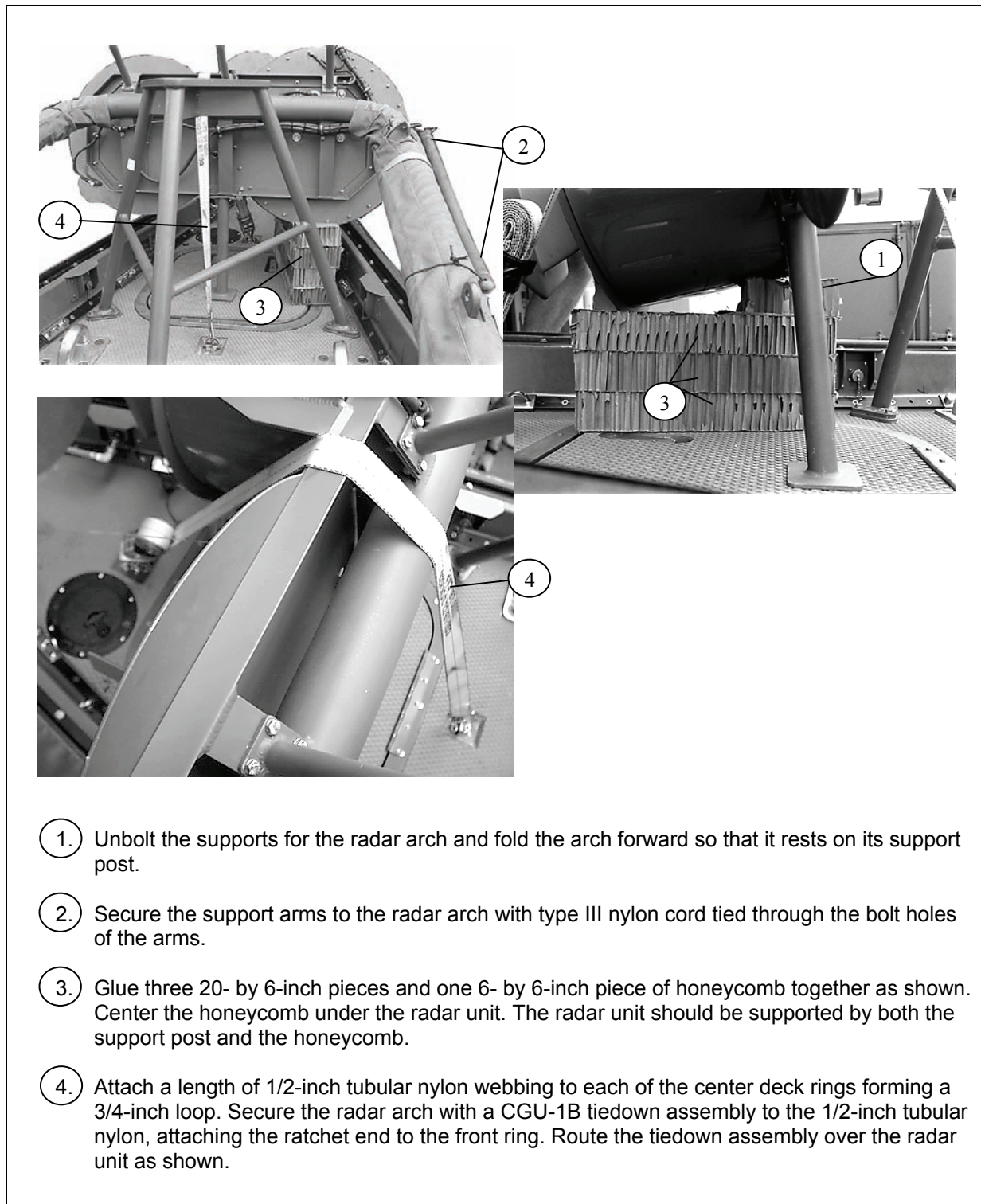

Figure 4-14. Radar Arch Folded and Secured

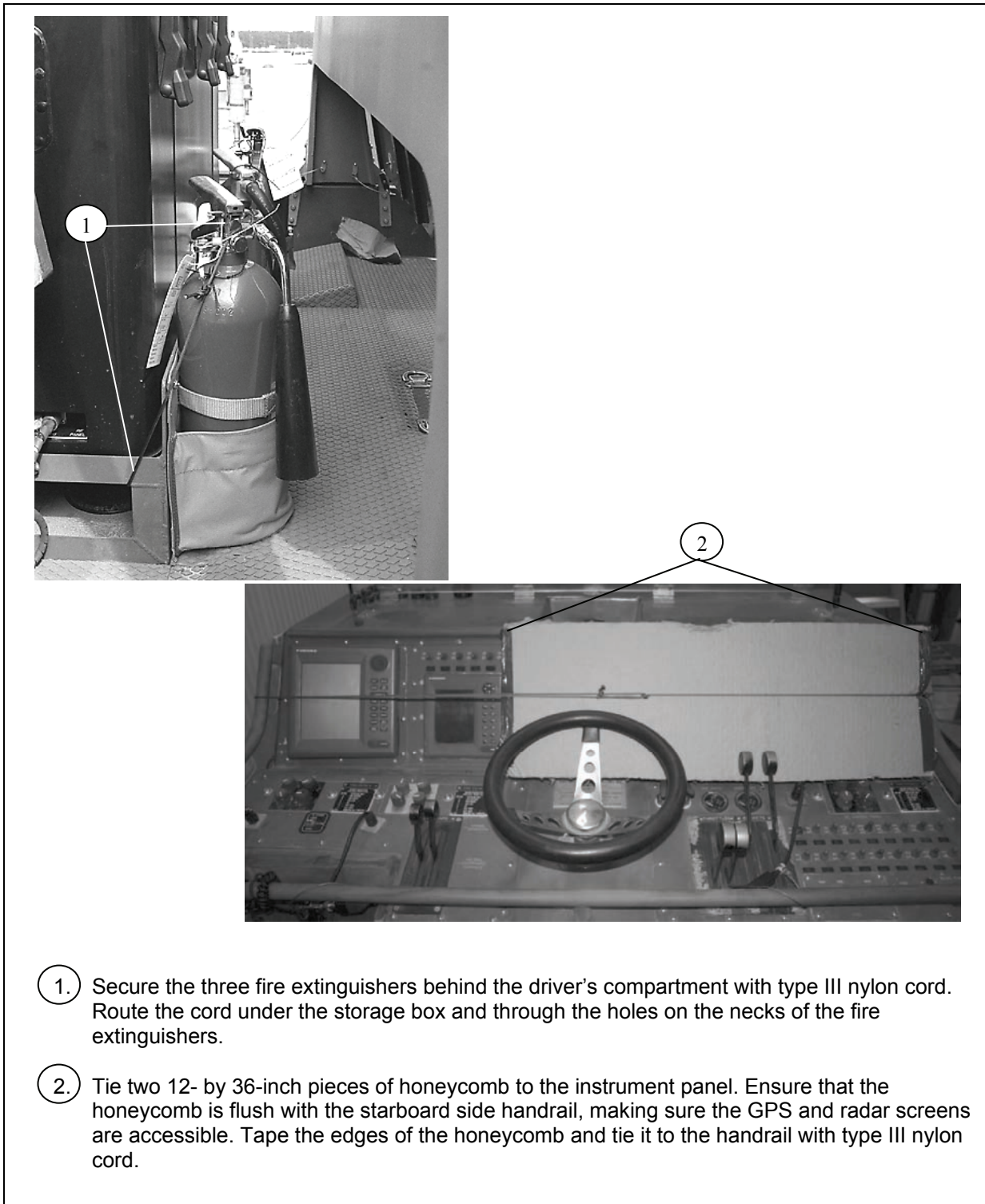
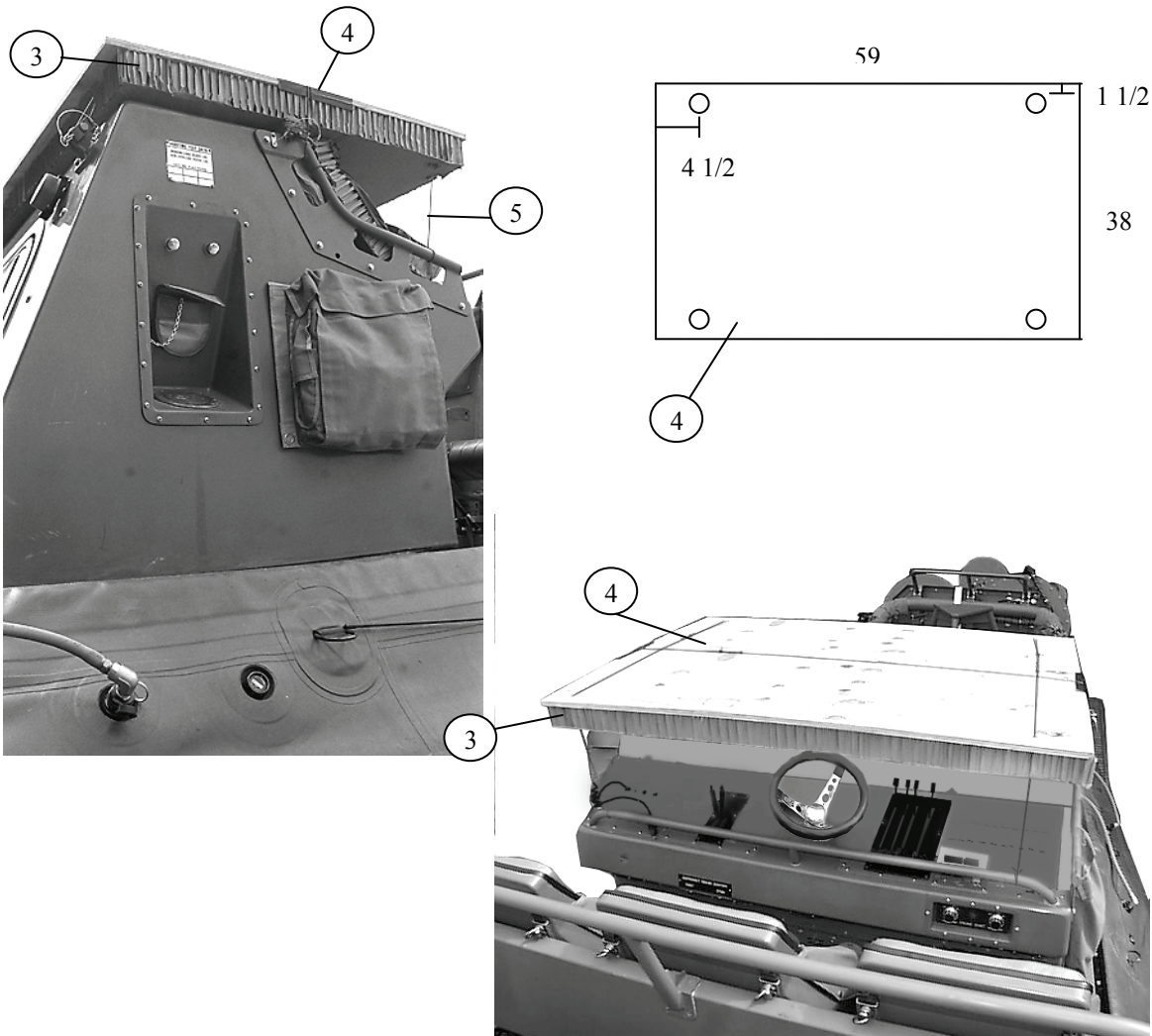

Figure 4-15. Console Prepared

Note. This drawing is not to scale and all dimensions are in inches.



3. Place a 36- by 59-inch piece of honeycomb over the folded windshield. Crush and cut to ensure that it completely covers the windshield surface. Ensure that the edge of the honeycomb and plywood is flush with the front of the console.
4. Drill 1/2-inch holes in a 1/2- by 38- by 59-inch piece of plywood as shown. Center and glue the plywood over the honeycomb placed in step 3 above. Center a type III nylon cord tie over the center of the plywood from the left to the right handrail.
5. Secure the plywood on each side to the console handrails, through the side holes in the plywood and to the push-pull pins.

Figure 4-15. Console Prepared (continued)

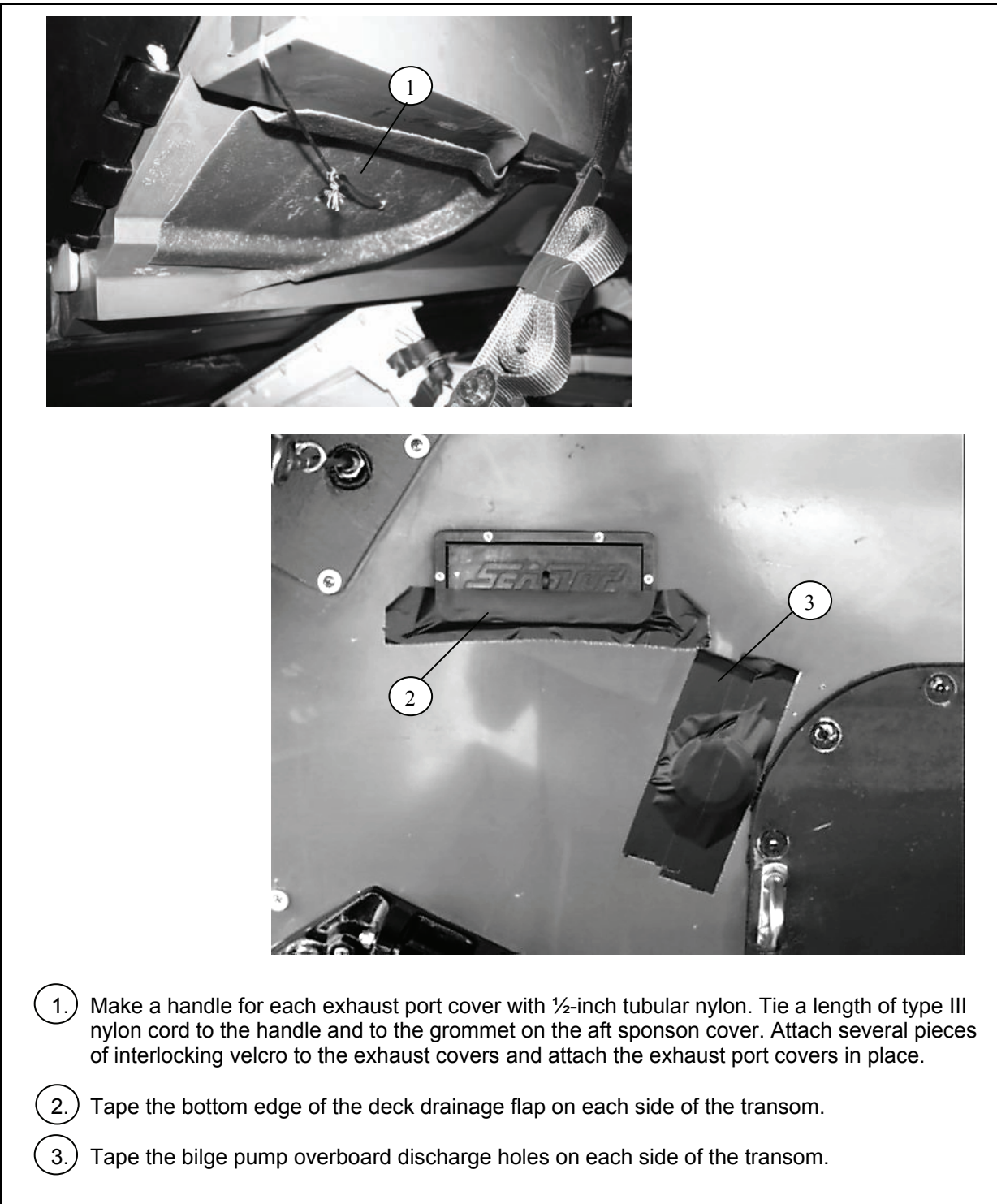

1. Make a handle for each exhaust port cover with ½-inch tubular nylon. Tie a length of type III nylon cord to the handle and to the grommet on the aft sponson cover. Attach several pieces of interlocking velcro to the exhaust covers and attach the exhaust port covers in place.
2. Tape the bottom edge of the deck drainage flap on each side of the transom.
3. Tape the bilge pump overboard discharge holes on each side of the transom.

Figure 4-16. Discharge Holes, Drainage Flaps, and Exhaust Port Covers Secured

PREPARING THE SPONSON INFLATION SYSTEM

4-7. Prepare the sponson inflation system as shown in Figure 4-17.

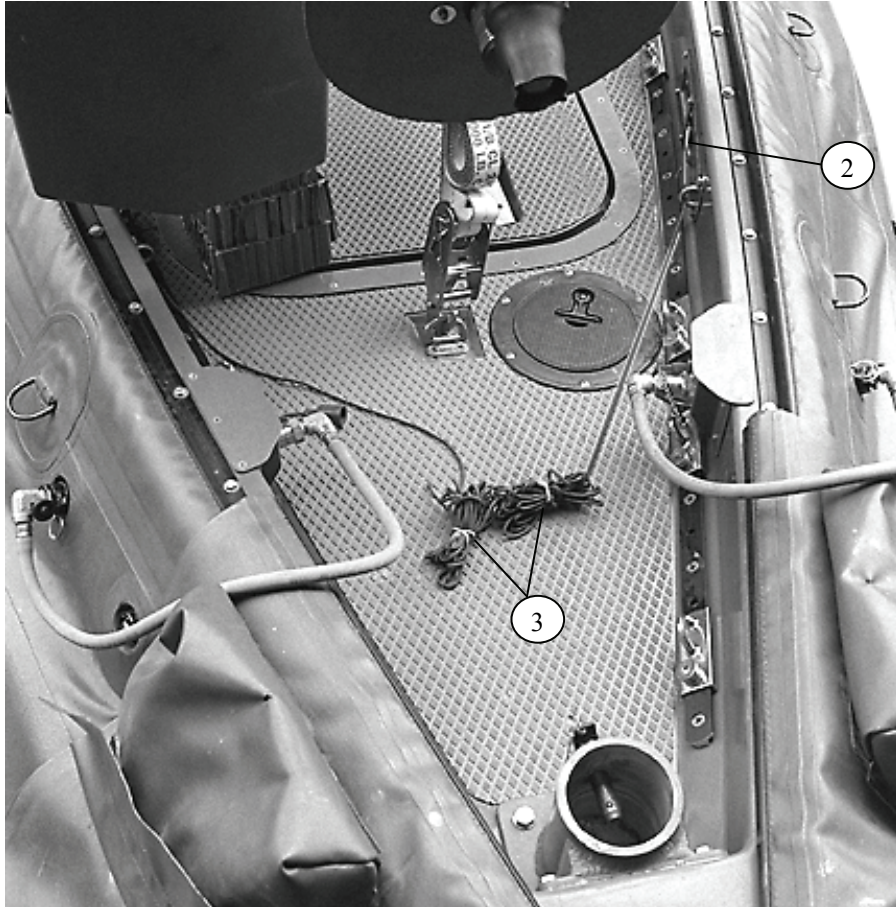

1. Make sure the hose connections for the sponson inflation system are tight (not shown).
2. Remove the core threads from two 6-foot lengths of type III nylon cord. Pass one end of the cord through the tiedown ring and tie it to the sponson activation cable ring. Repeat for the other side of the boat.
3. Fold the excess cord and secure with retainer bands in the middle of the deck.

Figure 4-17. Sponson Inflation System Connected

INSTALLING THE WATER ACTIVATED PARACHUTE RELEASE

4-8. Install the four water-activated parachute releases as shown in Figure 4-18.

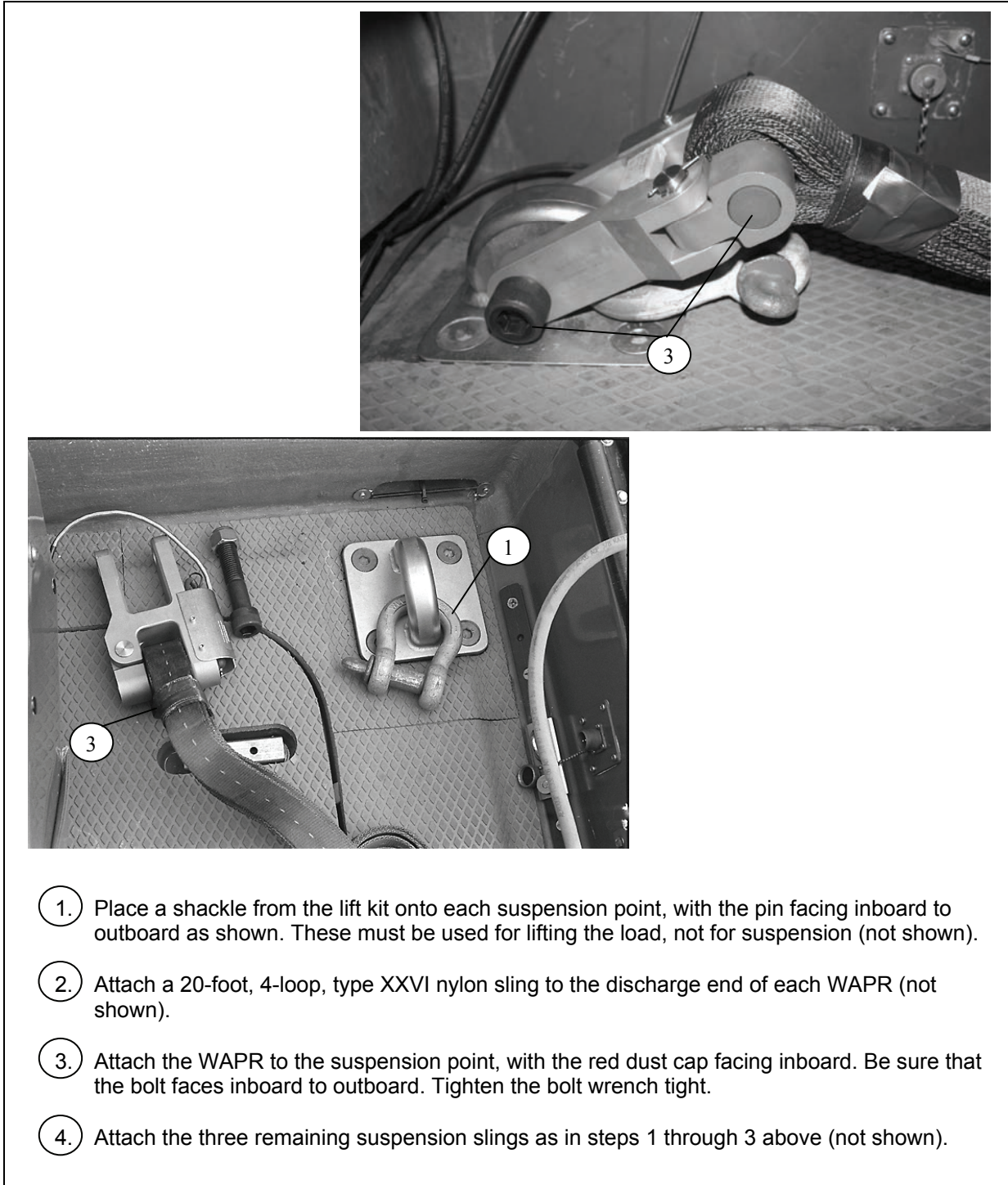

Figure 4-18. Water-Activated Parachute Releases Installed

INSTALLING THE BOAT COVER, SPONSON, TIES, AND SPONSON COVERS

4-9. Install the boat cover as shown in Figure 4-19. Make the sponson ties as shown in Figure 4-20. Install the aft sponson covers as shown in Figure 4-21.

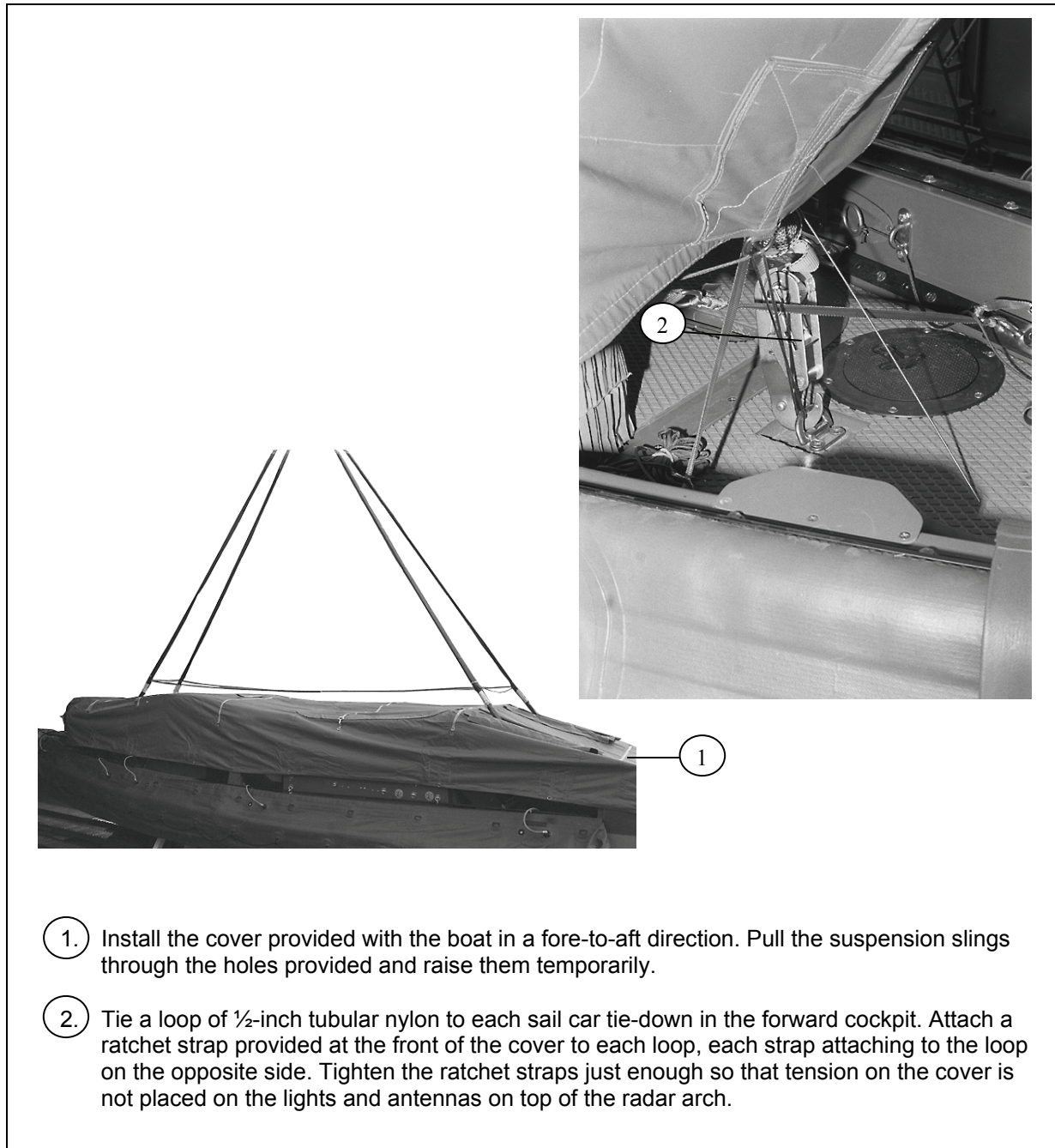

Figure 4-19. Boat Cover Installed